

ROPE DRUM

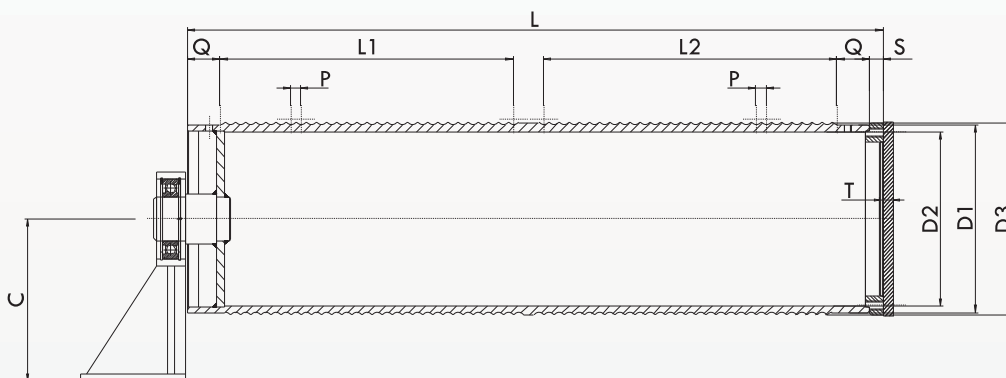

MAIN FEATURES

- Uses seamless tube of ASTM A106 Grade B
- 100% Machining done on CNC machining centers
- Strong pedestal made of casting
- Can be integrated with any gearbox using flange, shaft or coupling
- Hardened drum pedestal shaft
- Single reeving rope drums are supplied with rope guides



| Model | SWL (ton) | Reeving | P | D1 | D2 | D3 | Dimensions (mm) | | | | | | | | S | Q | C | T |
|---------|-----------|---------|------|-----|-----|-----|-----------------|-----|------|------|------|------|------|------|----|----|-----|----|
| | | | | | | | L1 | | | | L | | | | | | | |
| | | | | | | | 6m | 9m | 12m | 18m | 6m | 9m | 12m | 18m | | | | |
| ORD2101 | 1 | 2/1 | 8.8 | 159 | 155 | 164 | 228 | 329 | 430 | 631 | 307 | 408 | 509 | 710 | 15 | 32 | 100 | 20 |
| ORD2102 | 2 | 2/1 | 11 | 159 | 153 | 164 | 285 | 411 | 536 | 787 | 380 | 506 | 631 | 882 | 15 | 40 | 100 | 20 |
| ORD2103 | 3 | 2/1 | 13 | 208 | 202 | 215 | 265 | 379 | 493 | 721 | 381 | 495 | 609 | 837 | 20 | 48 | 130 | 20 |
| ORD2105 | 5 | 2/1 | 15.5 | 261 | 256 | 269 | 262 | 370 | 478 | 694 | 394 | 502 | 610 | 826 | 20 | 56 | 160 | 22 |
| ORD4102 | 2 | 4/1 | 8.8 | 159 | 155 | 164 | 430 | 631 | 833 | 1236 | 509 | 710 | 912 | 1315 | 15 | 32 | 100 | 20 |
| ORD4103 | 3 | 4/1 | 11 | 159 | 153 | 164 | 536 | 787 | 1038 | 1541 | 631 | 882 | 1133 | 1636 | 15 | 40 | 100 | 20 |
| ORD4105 | 5 | 4/1 | 13 | 208 | 202 | 215 | 493 | 721 | 949 | 1405 | 609 | 837 | 1065 | 1521 | 20 | 48 | 130 | 20 |
| ORD4110 | 10 | 4/1 | 15.5 | 261 | 256 | 269 | 478 | 694 | 910 | 1342 | 610 | 826 | 1042 | 1474 | 20 | 56 | 160 | 22 |
| ORD4205 | 5 | 4/2 | 13 | 208 | 202 | 215 | 265 | 379 | 493 | 721 | 742 | 970 | 1198 | 1654 | 20 | 48 | 130 | 20 |
| ORD4210 | 10 | 4/2 | 15.5 | 261 | 256 | 269 | 262 | 370 | 478 | 694 | 768 | 984 | 1200 | 1632 | 20 | 56 | 160 | 22 |
| ORD4216 | 16 | 4/2 | 20 | 341 | 334 | 352 | 273 | 380 | 486 | 699 | 864 | 1077 | 1290 | 1716 | 30 | 72 | 200 | 35 |
| ORD4220 | 20 | 4/2 | 22 | 390 | 385 | 402 | 271 | 374 | 476 | 681 | 892 | 1097 | 1302 | 1712 | 30 | 80 | 225 | 35 |
| ORD8216 | 16 | 8/2 | 15.5 | 261 | 256 | 269 | 478 | 694 | 910 | / | 1200 | 1632 | 2064 | / | 20 | 56 | 160 | 22 |
| ORD8220 | 20 | 8/2 | 15.5 | 261 | 256 | 269 | 478 | 694 | 910 | / | 1200 | 1632 | 2064 | / | 20 | 56 | 160 | 22 |

* Rope drums of different SWL and reeving are also available on request

* "L2" is not applicable in case of single reeving drums

* For more details and customization requests, please contact Liftech.